

## Quick Start Assembly/Installation Instructions

# CLEARSTREAM ECLIPSE™

Before beginning assembly, make sure all parts needed are present.

### READ BEFORE INSTALLATION:

Before attaching the antenna to any surface, **TEST RECEPTION** in that area. Connect the antenna to the TV or converter box and run a full channel scan. If reception is not as desired, move the antenna and rescan for the available channels.

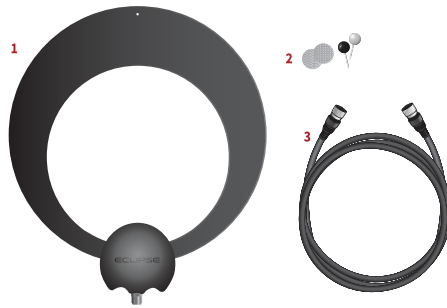

### The ClearStream ECLIPSE comes with:

- 1) ClearStream ECLIPSE Antenna
- 2) Hook & Loop Tabs and Push Pins
- 3) 12 ft. Coaxial Cable

### SET UP THE ANTENNA:

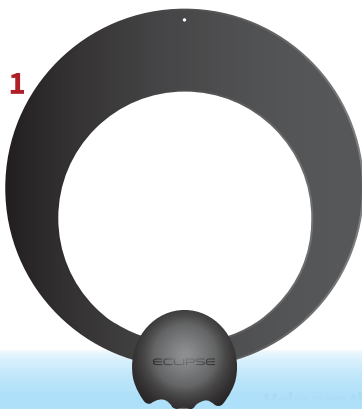

Attach the antenna to a wall or non-metallic surface using the included push pins in the small hole at the top of the antenna or on a window using the hook & loop tabs.

Clean any surface and allow to air-dry before using the hook & loop tabs.  
**The adhesive is strong - please take care when removing.**

**Make sure the antenna is facing the broadcast towers.**

3



Now that you've installed your antenna, you are ready to scan for channels. See "Scanning for channels" in the troubleshooting guide.

Congratulations! You're watching HDTV for FREE! Welcome to the Antennas Direct cord-cutting family.

TV RECEPTION CAN BE AFFECTED BY OBSTRUCTIONS OR DISTANCE BETWEEN YOUR HOME AND BROADCAST TOWERS.



Call us toll-free for technical assistance at **1-877-825-5572** or contact [support@antennasdirect.com](mailto:support@antennasdirect.com)

FIND TV CHANNELS, AIM YOUR ANTENNA

antenna point

**DOWNLOAD OUR FREE APP**

## TROUBLESHOOTING:

**Problem: I'm not getting any signals at all.**

**Possible causes:**

1. Analog-only televisions (manufactured before 2007) require a digital converter box. You **MUST** perform a channel scan on the converter box.

2. **SCANNING FOR CHANNELS:** A digital TV must be programmed in order to receive digital channels. Once your antenna is installed, you must complete a channel scan, even if you have done so before installing to find the best location for the antenna.

a) Your TV must be set to the proper input source. Press the "Input" (or "Source") button on your remote and make sure the input is set to TV.

b) Follow the instructions specific to the make and model of your television or converter box to set the signal type to "ANTENNA", "AIR", or "BROADCAST", **not "Cable"**.

c) Go to the main menu of your TV or converter box and complete a channel scan. This could be listed as "Auto Program", "Auto Tuning", or "Auto Channel Scan". Consult the owner's manual for your specific device and more precise guidelines. Be ready to experiment with various locations in your home. Remember to rescan for channels in every location.

3. Make sure the antenna is facing the broadcast tower locations serving your area. Visit [www.antennapoint.com](http://www.antennapoint.com) for more information on broadcasters and tower locations serving your area, or download the **free Antenna Point app** to your Android/iOS smartphone or tablet.

4. You do not have a clear line of sight to your local broadcast towers.

You might need to elevate and/or move your antenna. Remember to rescan for channels in every location.

5. You are outside the range of your antenna's capabilities.

Depending upon the distance between your home and the local broadcast towers, you may need a long range outdoor/attic antenna. Antennas Direct offers many models for this purpose.

6. You may have loose coaxial cable connections. Check ALL connections for a tight fit.

7. Building materials such as brick, metal siding, radiant barrier, or stucco can greatly reduce the incoming signal. Do not place antennas on metallic surfaces, this interferes with TV signal reception. Move your antenna to a window or wall facing the broadcast towers and rescan for available channels.

**Problem: I'm receiving every channel except for one.**

**Possible cause:**

1. You may need to rescan the TV tuner or converter box.

The channel you are not receiving may have its transmitter lower on the broadcast tower than the other transmitters and your line of sight is obstructed. Try elevating the antenna or moving it to another location. Repeat as needed.

**Problem: I'm having signal breakups, but I'm only two miles from the broadcast tower.**

**Possible cause:**

1. Your TV may be receiving interfering signals.

A larger/stronger antenna will not necessarily solve this problem. Consider moving the antenna, making sure it is not placed near metal objects or other antennas. Call our helpline or chat with us online at [antennasdirect.com](http://antennasdirect.com) for an analysis of your area and installation. We may be able to offer simple solutions.

## Before You Return, Call to Learn.



**Aim Toward Towers**  
For Tower Locations:  
[antennapoint.com](http://antennapoint.com)

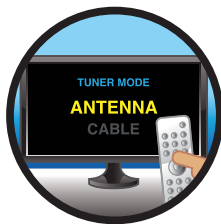

**Input on Antenna Mode**



**Scanning is a Must  
When in Doubt, Rescan**

**HELPLINE: 1-877-825-5572**  
MODEL # ECL

**Antennas Direct™ Inc.  
Antenna Lifetime Warranty**

Antennas Direct™ Inc. warrants this product against any defects in materials or workmanship for as long as you own the product. No warranty claim will be honored unless, at the time the claim is made, you present proof of purchase from an authorized Antennas Direct™ Inc. dealer.

Antennas Direct™ Inc. will either repair or replace the defective product at no charge to you. This warranty covers parts but does not cover any costs incurred in the removal or reinstallation of the product. This limited warranty does not apply if the product is damaged or fails due to: misuse, improper installation, abuse, and modification of the product as originally manufactured by Antennas Direct.

Antennas Direct™ Inc. will not assume any liabilities for any other warranties, expressed or implied by any other person. The foregoing shall be the sole and exclusive remedy of any person, whether in contract, tort, or otherwise, and Antennas Direct™ Inc. shall not be liable for incidental or consequential damage or commercial loss, or for any other loss or damage, as set forth above.

16388 Westwoods Business Park, Ellisville, MO 63021, USA

©Antennas Direct  
Model # ECL  
12.2024

**TV RECEPTION CAN BE AFFECTED BY OBSTRUCTIONS OR DISTANCE  
BETWEEN YOUR HOME AND BROADCAST TOWERS.**



Call us toll-free for technical assistance at **1-877-825-5572**  
or contact [support@antennasdirect.com](mailto:support@antennasdirect.com)

**FIND TV CHANNELS, AIM YOUR ANTENNA**

**antenna point**

**DOWNLOAD OUR FREE APP**