

GOLIATH

Before beginning assembly, make sure all parts needed are present.

Coaxial cable and mast sold separately.

READ BEFORE INSTALLATION:

Before permanently attaching the antenna to any surface, **TEST RECEPTION** in that area. Connect the antenna to the TV or converter box and run a full channel scan. If reception is not as desired, move the antenna and rescan for the available channels.

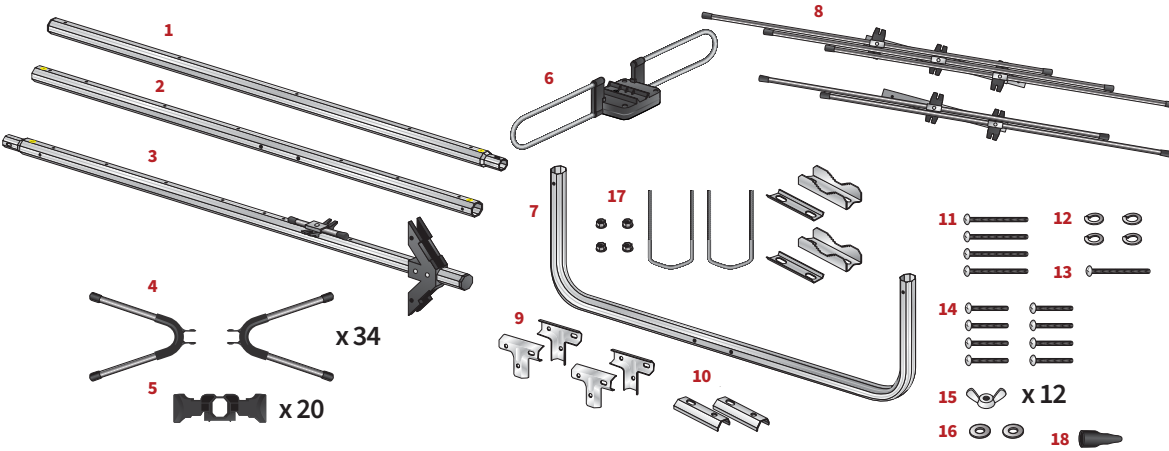

The Goliath comes with:

- 1) Front Boom
- 2) Middle Boom
- 3) Back Boom with Driven Element and Reflector Bracket
- 4) 34 - Directors
- 5) 20 - Director Holders with Retention Clips (includes 3 extra)
- 6) Balun Housing with Driven Element
- 7) U-shaped Support Bar
- 8) 2 - Reflector Sets (2 pc per Reflector)
- 9) 4 - T-brackets
- 10) 2 - Joining Brackets
- 11) 4 - 48 mm Screws
- 12) 4 - Spring Washers
- 13) 1 - 45 mm Nylon Screw for Balun Assembly
- 14) 8 - 35 mm Screws
- 15) 12 - Wing Nuts
- 16) 2 - Washers
- 17) 2 - U-Bolts, 4 - Flange Nuts, 2 - Mast Clamps, 2 - Boom Plates
- 18) Weather Boot

SET UP THE ANTENNA:

Required: Mast and coaxial cable (sold separately), Adjustable wrench, 13 mm Ratcheting driver, and a #2 Phillips screwdriver.

REFLECTOR ASSEMBLY

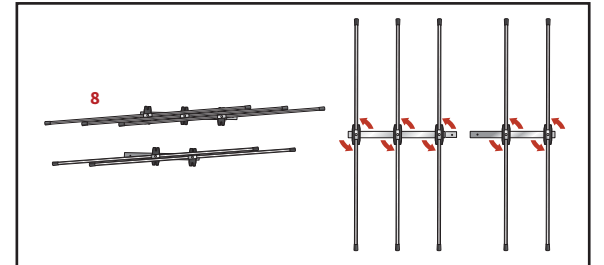

To assemble the antenna, join the three sections of the Boom (1, 2, and 3). The holes in all three Booms should be facing up when assembling.

Use the Joining Brackets (10) to secure the Booms as shown. Attach the U-shaped Support Bar (7) to the underside of the Middle Boom (2) and the Back Boom (3) using the T-brackets (9), 35 mm Screws (14), and Wing Nuts (15) as shown.

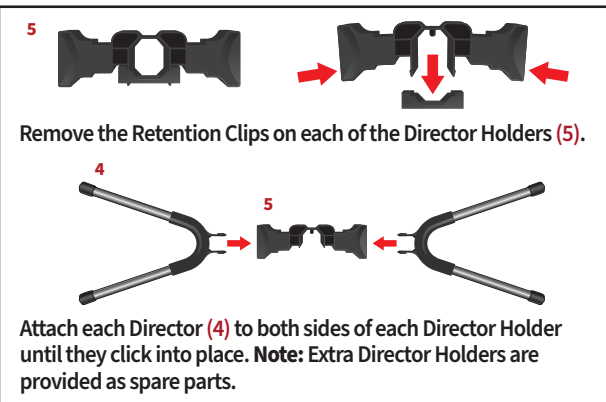

Remove the Retention Clips on each of the Director Holders (5).

Attach each Director (4) to both sides of each Director Holder until they click into place. **Note:** Extra Director Holders are provided as spare parts.

To fit the Director Holders (5) onto the Boom, line up the alignment pin inside the Director Holder with the hole on the Boom and press into the corresponding hole. Attach the Retention Clip to the Director Holder until it snaps into place. **Note:** Each Director Assembly is identical and can be assembled in any order.

Turn the Driven Element at the end of the Back Boom (3) until it clicks into place. Attach the Balun Housing with Driven Element (6) to the underside of the Back Boom (3) using one 45 mm Nylon Screw (13).

Assemble the Reflector Sets (8) by turning all the reflector bars until they snap into place as shown above (see "Reflector Assembly"). Combine each 3-bar reflector assembly with a 2-bar reflector assembly using a 35 mm Screw (14), a Washer (16), and a Wing Nut (15) as shown, for each set. Slide each Reflector Assembly into the Back Boom (3) so it nests inside the Reflector Bracket as shown. Secure each Reflector Assembly with the 48 mm Screws (11) and Spring Washers (12), and 4 x Wing Nuts (15).

INSTALLATION ON THE MAST:

IMPORTANT: CHECK THE RECEPTION IN THE LOCATION WHERE YOU INTEND TO INSTALL THE ANTENNA PRIOR TO ATTACHING THE MAST TO ANY SURFACE. SEE "SCANNING FOR CHANNELS" IN THE TROUBLESHOOTING GUIDE.

Before installing the antenna on a mast, adjust the mast, so it is in a vertical position. You will need to adjust the antenna after it is mounted for the best reception.

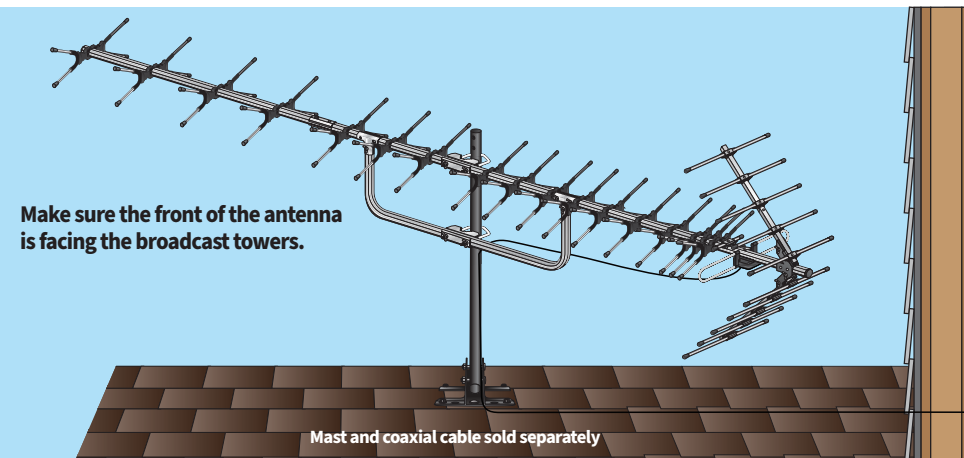
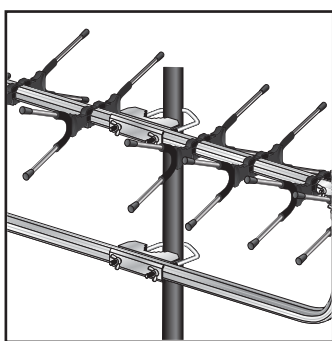

Make sure the front of the antenna is facing the broadcast towers.

Mast and coaxial cable sold separately

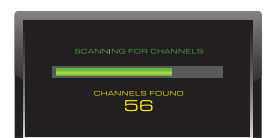

Now that you've installed your antenna, you are ready to scan for channels. See "Scanning for channels" in the troubleshooting guide.

Congratulations! You're watching HDTV for FREE! Welcome to the Antennas Direct cord-cutting family.

TV RECEPTION CAN BE AFFECTED BY OBSTRUCTIONS OR DISTANCE BETWEEN YOUR HOME AND BROADCAST TOWERS.



Call us toll-free for technical assistance at **1-877-825-5572** or contact support@antennasdirect.com

FIND TV CHANNELS, AIM YOUR ANTENNA

antenna point

DOWNLOAD OUR FREE APP

TROUBLESHOOTING:

Problem: I'm not getting any signals at all.

Possible causes:

1. Analog-only televisions (manufactured before 2007) require a digital converter box. You **MUST** perform a channel scan on the converter box.
2. **SCANNING FOR CHANNELS:** A digital TV must be programmed in order to receive digital channels. Once your antenna is installed, you must complete a channel scan, even if you have done so before installing to find the best location for the antenna.
 - a) Your TV must be set to the proper input source. Press the "Input" (or "Source") button on your remote and make sure the input is set to TV.
 - b) Follow the instructions specific to the make and model of your television or converter box to set the signal type to "ANTENNA", "AIR", or "BROADCAST", **not "Cable"**.
 - c) Go to the main menu of your TV or converter box and complete a channel scan. This could be listed as "Auto Program", "Auto Tuning", or "Auto Channel Scan". Consult the owner's manual for your specific device and more precise guidelines. Be ready to experiment with various locations in your home. Remember to rescan for channels in every location.
3. Make sure the front of the antenna is facing the broadcast tower locations serving your area. Visit www.antennapoint.com for more information on broadcasters and tower locations serving your area, or download the **free Antenna Point app** to your Android/iOS smartphone or tablet.
4. **Outdoor Use:** You do not have a clear line of sight to your local broadcast towers. You might need to elevate and/or move your antenna. Make certain the antenna is not aimed into physical obstacles such as a roof, building, or trees. Remember to rescan for channels in every location.
5. You are outside the range of your antenna's capabilities. Depending upon the distance between your home and the local broadcast towers, you may need a longer range outdoor/attic antenna. Antennas Direct offers many models for this purpose.

6. You may have loose coaxial cable connections. Check ALL connections for a tight fit and check all outdoor connections for moisture or corrosion.
7. **Indoor Use:** Building materials such as brick, metal siding, radiant barrier, or stucco can greatly reduce the incoming signal. If in an attic, move the antenna outdoors. If outdoors, make certain the antenna is not aimed into physical obstacles, such as buildings, trees, or a hill. Remember to rescan every time you move your antenna.

Problem: I'm receiving every channel except for one.

Possible cause:

1. You may need to rescan the TV tuner or converter box. The channel you are not receiving may have its transmitter lower on the broadcast tower or on a different tower than the other transmitters and your line of sight is obstructed. Try elevating the antenna or moving it to another location. Repeat as needed.

Problem: I'm having signal breakups, but I'm only two miles from the broadcast tower.

Possible cause:

1. Your TV may be receiving interfering signals. A larger/stronger antenna will not necessarily solve this problem. Consider moving the antenna, making sure it is not placed near metal objects or other antennas. If this is not successful, your signal may be too strong and may require the use of an attenuator. Call our helpline or chat with us online at antennasdirect.com for an analysis of your area and installation. We may be able to offer simple solutions.

Before You Return, Call to Learn.



For Tower Locations:
antennapoint.com

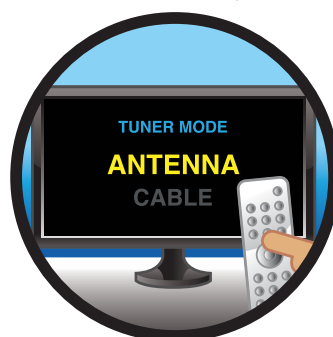

Input on Antenna Mode



Scanning is a Must
When in Doubt, Rescan

HELPLINE: 1-877-825-5572

MODEL # GOLIATH

Antennas Direct™ Inc.
Antenna Lifetime Warranty

Antennas Direct™ Inc. warrants this product against any defects in materials or workmanship for as long as you own the product. No warranty claim will be honored unless, at the time the claim is made, you present proof of purchase from an authorized Antennas Direct™ Inc. dealer.

Antennas Direct™ Inc. will either repair or replace the defective product at no charge to you. This warranty covers parts but does not cover any costs incurred in the removal or reinstallation of the product. This limited warranty does not apply if the product is damaged or fails due to: misuse, improper installation, abuse, and modification of the product as originally manufactured by Antennas Direct.

Antennas Direct™ Inc. will not assume any liabilities for any other warranties expressed or implied by any other person. The foregoing shall be the sole and exclusive remedy of any person, whether in contract, tort, or otherwise, and Antennas Direct™ Inc. shall not be liable for incidental or consequential damage or commercial loss, or for any other loss or damage, as set forth above.

16388 Westwoods Business Park, Ellisville, MO 63021, USA

©Antennas Direct
Model # GOLIATH
10.2024

TV RECEPTION CAN BE AFFECTED BY OBSTRUCTIONS OR DISTANCE
BETWEEN YOUR HOME AND BROADCAST TOWERS.



Call us toll-free for technical assistance at **1-877-825-5572**
or contact support@antennasdirect.com

FIND TV CHANNELS, AIM YOUR ANTENNA

antenna point

DOWNLOAD OUR FREE APP